

USER MANUAL



Thank you for choosing Better Bathrooms.
Please read this manual before installing your product
and keep for future reference.

better 
bathrooms

Product name: Brushed Brass Modern Traditional Concealed 2 Outlet Valve - Lyla

Product code/s :LYBBC2OV

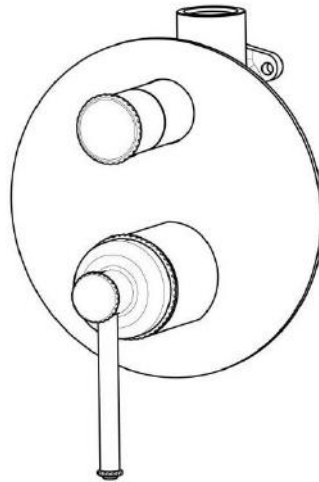

- **Single-person assembly**
- **Tools required**
- **We always recommend using professional tradespeople to install your product**

V1_10.06.2025

Congratulations on your purchase

And welcome to our growing gang of savvy shoppers

We're on a mission to bring you extraordinary bathroom products, for less. From modern to traditional style ceramics, plus the gorgeous fixtures, fittings and furniture to match. So, you can fall in love with your space every single day.

As one of the UK's largest independent bathroom stores, we've received countless awards; including the National Business Awards UK, the Digital Entrepreneur Awards and being placed on The Sunday Times Fast Track 100.

We hope your new product goes above and beyond your expectations. However, should any problems occur, please:

- log in to your account and contact our customer services team via your self-serve portal – betterbathrooms.com/CustomerAccount/Login
- contact us via betterbathrooms.com/content/contact-us

Important information

- Please read these instructions thoroughly and retain for future reference
- Pressures should meet minimum stated on the website
- Pressures must be balanced for optimum performance
- Always check for pipes and cables before drilling

Contents

- 1.Wall shower valve
- 2.Back plate (O- rings included)
3. Diverter handle
- 4.Handle
- 5.Spare parts (Allen key and Screw)
- 6.Wall screws and wall plugs

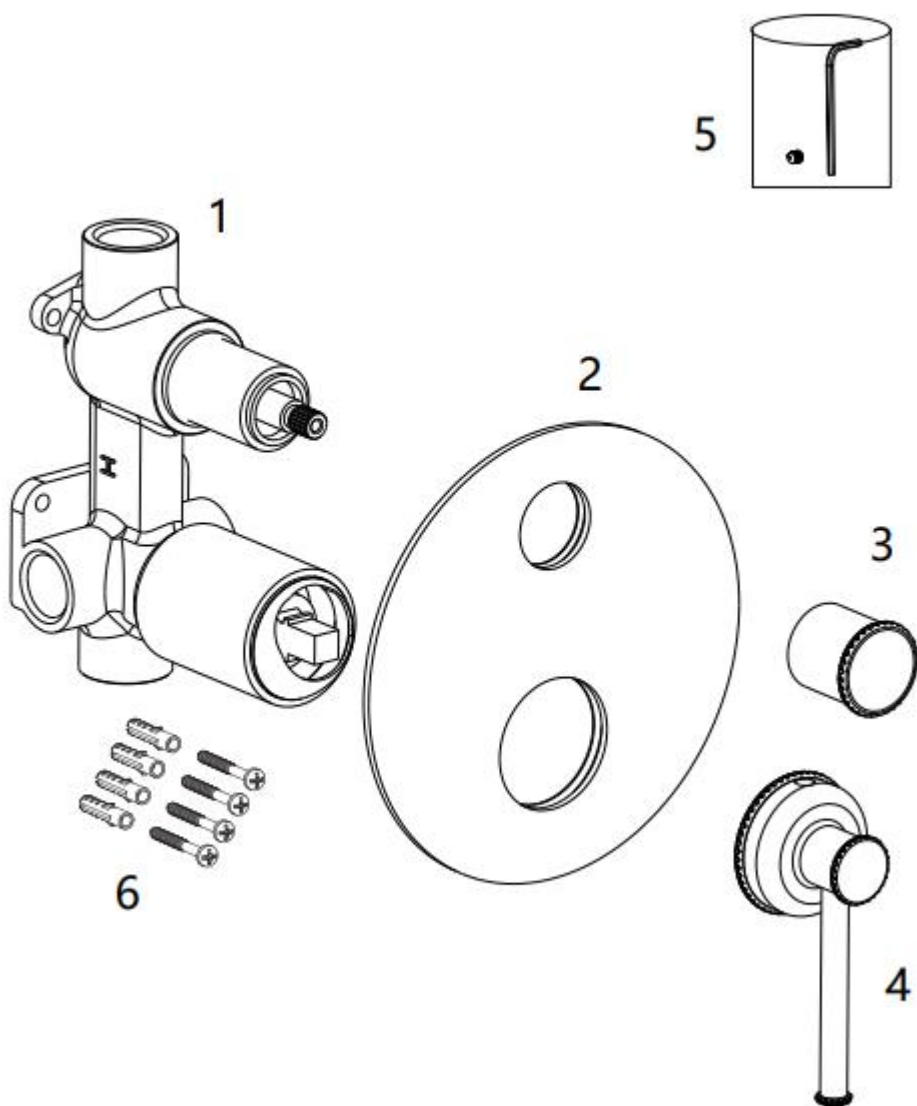

Parts / Diagrams

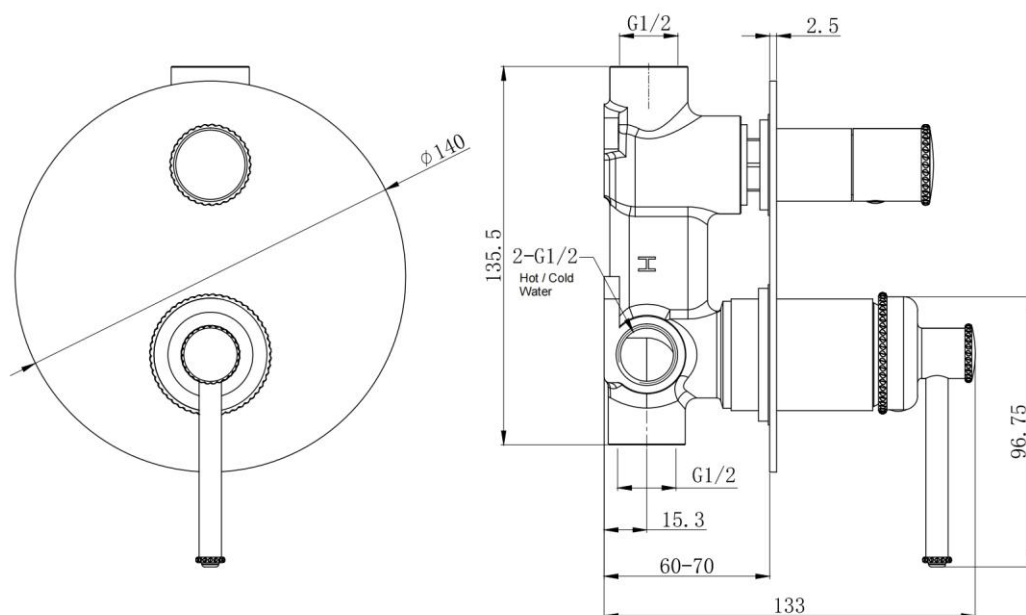

Tools required

Installation requires a screwdriver, adjustable wrench, adjustable pliers, and drill, PTFE sealing tape, pencil, silicone.

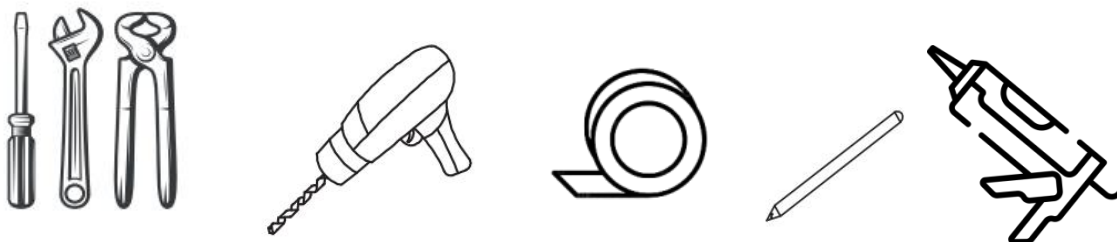

Installation

1. Select the position for the shower valve and offer the shower valve to the wall, mark the 4 fixing points at the top and bottom with a suitable pencil.

Remove the shower valve from the wall, drill the holes to a suitable depth for the wall plugs and secure with supplied screws.

The valve must be set into the wall by 60-70mm(see dimension page).

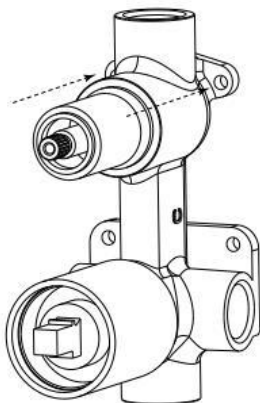

2. Connect hot supply to left inlet of the valve and cold supply to right inlet.

Connect the top and bottom outlet to the shower options.

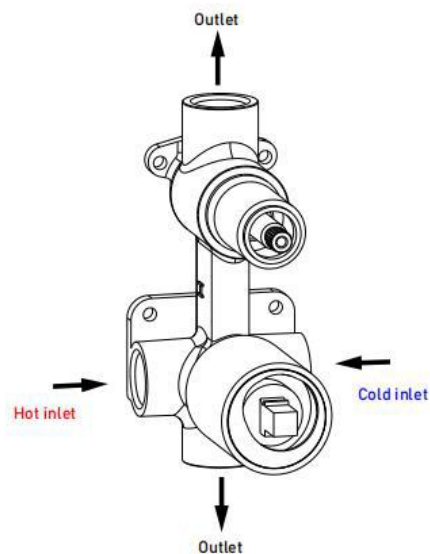

3. Turn on the water supply and check for leaks before fitting the back plate.

Use silicone to seal the back plate.

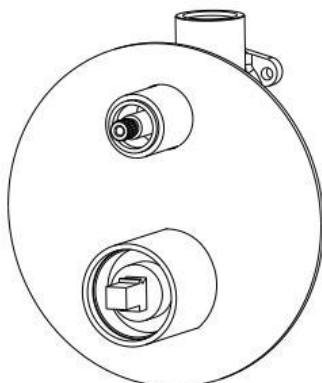

4. Carefully slide the diverter handle onto the shower valve. Secure the handle by tightening the grub screw using the supplied Allen key.

Carefully slide the control handle onto the shower valve. Fix the handle by tightening the grub screw with the supplied Allen key.

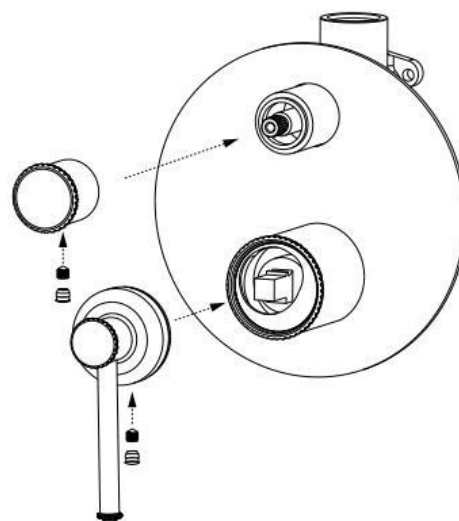

Operation

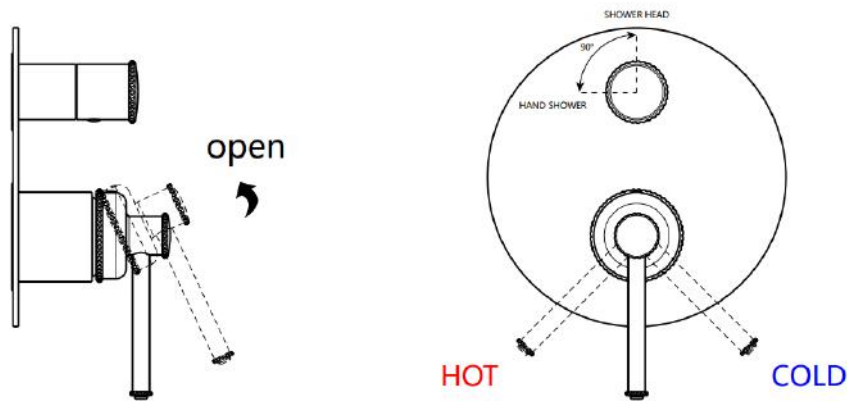

Troubleshooting

Fail	Cause	Solution
Insufficient water flow	Incoming water pressure is low.	Check with your local water supply pressure.
	Mixer cartridge inlet is dirty or blocked.	Remove and clean the cartridge.
Water dripping after closed	Loose mixer cartridge.	Remove, check and clean the mixer cartridge.
	Damaged mixer cartridge.	Replace the cartridge with a new one.
Diverter incorrectly	Diverter cartridge clogged.	Clean diverter cartridge-Soak in vinegar 30 minutes. Replace new diverter cartridge.

Maintenance

Mixer cartridge

- 1) Remove the handle (A&B) ,dome (C) and locking nut (D).
- 2) Pull out the mixer cartridge (E).
- 3) Wash the cartridge with clean running water, dry and lightly grease the seals(only use silicone grease).
- 4) Put back the cartridge, then tighten the locking nut.
- 5) Install the dome and handle. Test and commission.

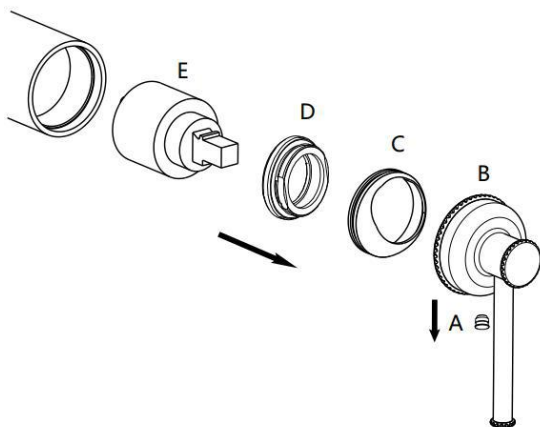

Diverter cartridge

- 1) Remove the diverter handle (A&B) and mixer handle(C&D).
- 2) Take out the back plate (E) and unscrew out the diverter sleeve.
- 3) Pull out diverter cartridge .Wash the cartridge with clean running water, dry and lightly grease the seals(only use silicone grease).
- 4) Reinstall the product by reversing the assembly steps.

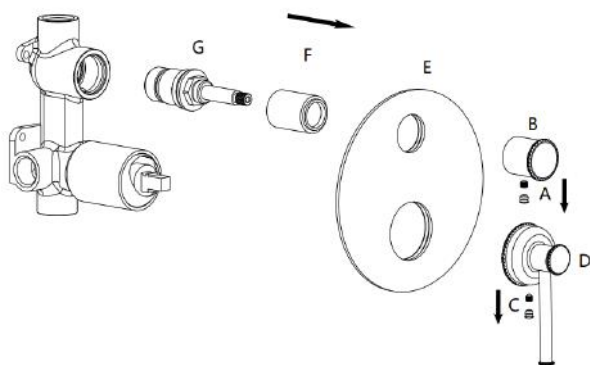

Cleaning

Clean the product surface with a soft cloth and a mild detergent or citric acid solution. The use of any rough materials, as well as corrosive or abrasive cleaning agents, is not recommended as they may cause damage to the coating.

For more information

- visit betterbathrooms.com
- email customerservices@buyitdirect.co.uk
- call 0330 390 3062
- write to Trident Business Park, Neptune Way, Huddersfield, HD2 1UA

**better
bathrooms**

Part of the BuyItDirect Group